

DATASHEET

Magnetically coupled pump

1 – stage 60Hz

Motor output
1,5kW / 2,2kW / 3,0kW / 4,0kW
3450 rpm [2-pol.] 60Hz



RM-MS 1 Type 32/300*

Magnetically coupled, centrifugal pumps, 1-stage, horizontal, non self-priming, made in monobloc design.

		RM-MS 1 Type 32/300*									
Motor output		[kW]	1,5		2,2		3,0		4,0		
Rated current @ 400V 50Hz 3-ph.		[A]	3,25		4,75		6,0		8,6		
Head max.		[mWS]	32		32		32		32		
Capacity max.		[l/min.]	160		300		300		300		
Density max. @ Qmax		[g/cm ³]	1,0		1,2		1,6		2,2		
Length „L“	IE2	IE3	[mm]	450	495	500	514	520	533	520	563

Materials:



Only for
3450 rpm !!

Technical data

Medium-temperature max.	PP PVDF	80 °C 90 °C
System-pressure max.	PP PVDF	8,0 bar 8,0 bar
Viscosity	< 160 Pa s	
Electrical motor	3-ph. motors, 50 and 60Hz, IE2, IE3 or IE4 Protection IP55, Isolationclass F , Chemical resistant 2K- painting RAL5011	
Options	<i>Thermal protection, other voltages / frequencies, UL, CSA, Special paintings and colors</i> 	

Flow curves RM-MS Type 32/300

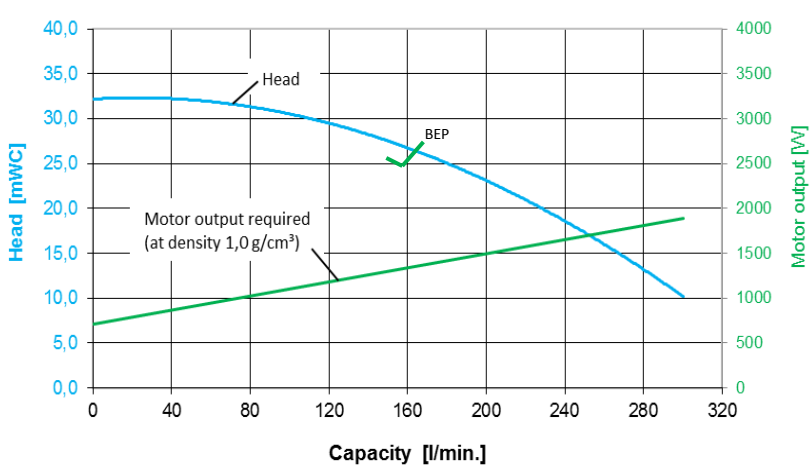

Speed: 3450 rpm @ 60Hz

Values based on water at 20 °C (68 °F) / Measured value +/- 10%

Subject to technical alterations !

DATASHEET
Magnetically coupled pump
1 – stage 60Hz

RM-MS 1 Type 32/300*

Motor output

1,5kW / 2,2kW / 3,0kW / 4,0kW
3450 rpm [2-pol.] 60Hz



Dimensional drawings

Motor output 1,5kW - 4,0kW IE2 (1,5kW + 2,2kW + 3,0kW IE3) 2-pol.

1-stage

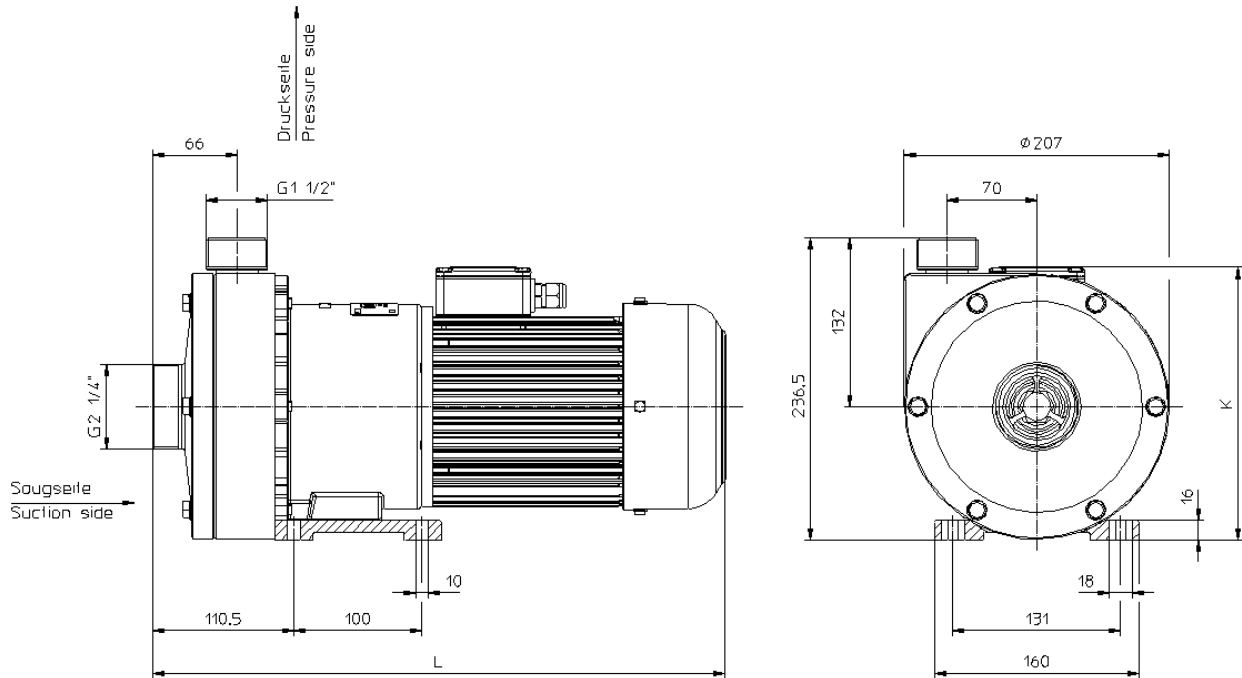

Dimensions in [mm] !

Motor dimensions can be different ! ● Subject to technical alterations !

DATASHEET
Magnetically coupled pump
1 – stage 60Hz

RM-MS 1 Type 32/300*

Motor output
 1,5kW / 2,2kW / 3,0kW / 4,0kW
 3450 rpm [2-pol.] **60Hz**

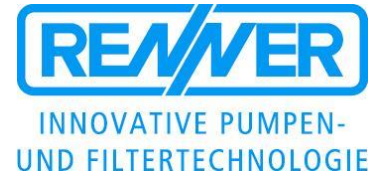

Accessories / Options

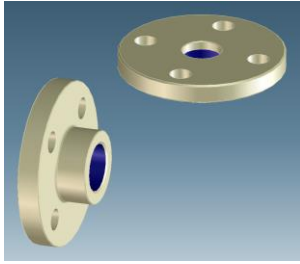
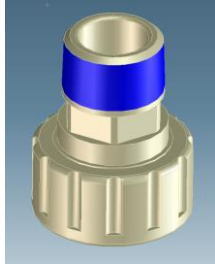
Hose connection	Flange (DIN, ANSI)	NPT - Adapter
 <p>32mm 40mm 50mm</p>	 <p>DN40 PN10 (DIN EN 1092-3) DN32 PN10 (DIN EN 1092-3) 2" (ANSI Class 150) 1.5" (ANSI Class 150)</p>	 <p>NPT (M) 2" NPT (M) 1.5"</p>

Monitor and protect your pump and your process !

Electronic process monitoring -> RPR-Control



- Monitoring the filter fouling
- Dry running
- Overheating
- Overload

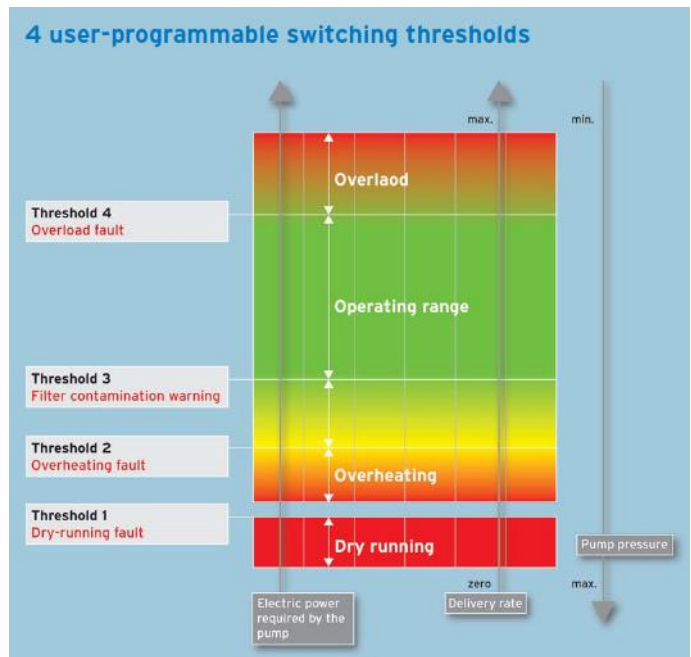

Subject to technical alterations !